Mounting & Maintenance

OSPW System

For Campagnolo 12-Speed EPS



CERAMICSPEED

Maintenance

No set of rules can be made for how often your Oversized Pulley Wheels is to be maintained. Maintenance frequency depends on the weather conditions that you are riding in.

A worn chain will increase the wear on the pulley wheels significantly, so make sure that you change your chain before it is completely worn out. Under normal conditions, we recommend that you service the Oversized Pulley Wheels when you have ridden under wet conditions, washed your bike or each time you lubricate the chain. For normal maintenance, add a drop of oil into the lubrication points (see the page 3) for optimal performance. Make sure to position the OSPW System horizontally to ensure that the oil reaches the Oversized Pulley Wheel bearings.

We recommend the use of CeramicSpeed Oil on the OSPW System. This can be purchased from the CeramicSpeed dealers worldwide or from our webshop. Watch our maintenance video on ceramicspeed.com in the Support section.

When travelling, your OSPW System will not fit in the bike travelling bag. We recommend that you dismount the whole rear derailleur and pack it aside.

Extended Maintenance

Approximately once every half a year we recommend that you perform an extended maintenance. In this case, you should dismount the Oversized Pulley Wheels from the cage, remove the seals from both sides and clean all parts in a shaker with degreaser. After cleaning, dry the components off, put two drops of oil onto the CeramicSpeed Balls, place the seals back on and remount the Oversized Pulley Wheels. When dismounting the cage plates, you will need a 2.5 mm Allen Key for the pulley wheel bolts (see page 3) and a 2 mm Allen key for the tower bolts. To remount the screws, tighten the pulley wheel screws up to a max torque of 1 Nm and the tower bolts up to 0.3 Nm. For this, a torque tool is recommended. If you're riding in wet and muddy conditions, we recommend you to perform an extended maintenance more frequently and replace oil with All Round Grease for better protection.

Mounting the CeramicSpeed Oversized Pulley Wheel System for Campagnolo 12-speed EPS:

Pos.	Description
1	Pulley wheel bolts
2	Tower bolts
3	Back cage plate
4	Upper pulley
5	Lower pulley
6	Lock ring
7	Front cage plate

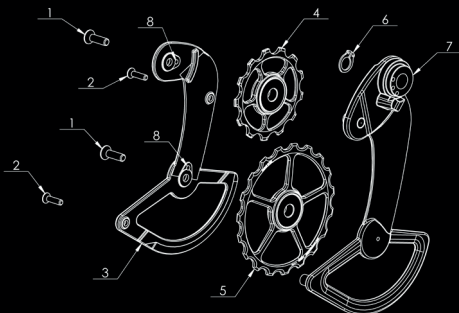

Tools required

For the installation of your new CeramicSpeed OSPW System for Campagnolo 12-speed EPS you will need the following tools:

- A: 2,5mm Allen key
- B: 3mm Allen key
- C: Chain Tool
- D: Snap ring pliers
- E: Flat head screwdriver
- F: Lock ring mounting tool

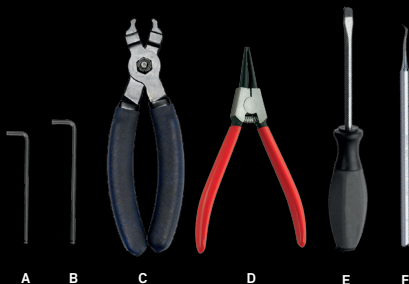

Mounting Manual

To ensure the very best in riding performance it is vital that your new OSPW System is mounted correctly. Follow these instructions to install your OSPW System for Campagnolo 12-speed EPS:



1. Begin with your bike mounted in a stand. Shift to the bottom of the cassette (smallest rear cog), remove the rear wheel and the chain. A longer chain will be required for the successful installation of the Ceramicspeed OSPW cage.



2. Remove the original upper and lower pulley wheel.



3. Now the c-clip and silver washer is visible and available for disassembly.

Shift the derailleur up to the middle of range.



4. With a flat head screwdriver, remove the c-clip and silver washer. These items are held under spring tension and could pop out. Be careful not to lose the silver washer as it will be re-used. You can reuse the factory c-clip, or the provided snap ring (6).



5. Carefully remove the front cage plate.



6. These 3 items should be reused.



7. Apply grease to the spring ends and place one end into the medium tension setting. (marked M on the front of the cage).



8. Assemble the OSPW with the derailleur body - making sure that the spring end fits into the embedded hole located inside of the derailleur body.



9. Wind the OSPW System counter clockwise (Cage pointing upwards and wound backwards) while holding the cage against the derailleur body. Once you reach the rotation stop tower, carefully allow the cage to ramp over the tower and secure into place. The cage is now under spring tension and may snap outwards. Be sure to continuously keep pressure on the OSPW cage against the derailleur body.



10. Place the original washer over the mounting post, against the OSPW cage, followed by the c-clip or the snap ring.



11. Once the cage is secured, ensure the cage pivots freely and the spring tension pulls it backwards properly.

Shift the derailleur down to the bottom (where the smallest cog would be) and install the Ceramicspeed pulley wheels.

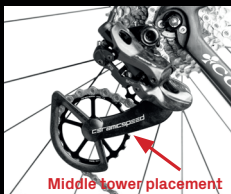

12. The chain must run over the middle tower. Follow the chain length guide below for measuring the chain length. Use our chain length guide on the following pages.

Adjust the gear shifting and the high and low limits. Test the bike carefully in all gears before using it on the road.

ATTENTION

Adjustment of the low limit on the EPS derailleur is electronic. You will need to make a general calibration of the gear shifting. As a part of the calibration the adjustment of the high and low stop positions will be performed during calibration.

Regarding adjustment of the Campagnolo EPS derailleur please refer to the official Campagnolo website. All relevant information on EPS calibration and adjustment can be found there including the zero setting of EPS.

Spring tension

Select the medium (M) spring tension setting for initial installation. If riding rough road conditions or if you feel the need for even great shift speed that the M setting, we recommend using the highest (H) tension setting. We reserve the lowest (L) tension setting for special setup circumstances.

Chain length

This is a guide for achieving the correct chain length after mounting a CeramicSpeed OSPW System. Please follow this guide in order to achieve precise shifting and performance of the OSPW System.



STEP 1: Place the chain on the small chain ring and the smallest cog on the cassette. To find the correct chain length, pull the two chain ends together, just as you would when needing to cut a chain to length. The lower part of the cage should start to move downwards, away from the cassette, as referenced in the second image.

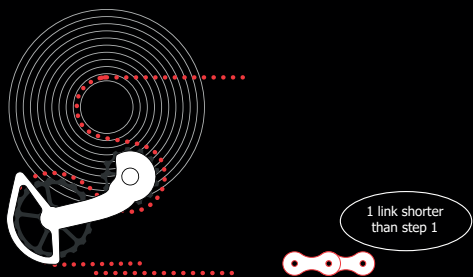

STEP 2: When tension is applied on the chain and the OSPW System appears to be aligned as the diagram above, the chain needs to be cut (1 link shorter than step 1) and connected by the required amount of links in order to achieve sufficient tension in this gear combination (always the small cog on the cassette).

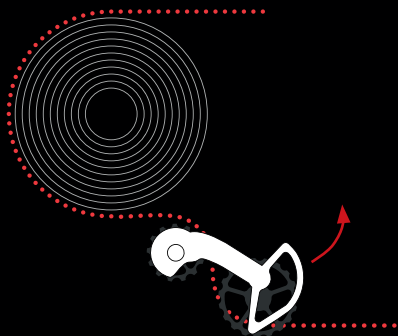

STEP 3: With the chain now cut to length it is important to test the clearance of the OSPW System when rear derailleur is set in the biggest chain ring and the largest cog on the cassette. Just as the arrow indicates the cage should be able to rotate counter clockwise. It is important that there is some clearance between the upper pulley wheel of the OSPW System and the largest cog on the cassette. If you find the clearance is not enough, adjust the B-tension accordingly.

NB: Some Campagnolo RD's dont have a B-tension setting. In this case simply adjust by chain length. On Campagnolo (B-tension or not) choose either 110 or 112 links by selecting the longest that clears the longest cog.

Up to 6 years warranty

Thankfully, we do not have to deal with warranty issues often. Nevertheless, we are happy to introduce you to our comprehensive warranty program.

Standard products 4 years

Bottom Brackets
Pulley Wheels
Wheel Kits
Headsets
Oversized Pulley Wheel Systems
Single Bearings

Coated products 6 years

Bottom Brackets
Pulley Wheels
Wheel Kits
Headsets
Oversized Pulley Wheel Systems
Single Bearings

We are committed to manufacturing and delivering the best ceramic bearing products in the industry. Should your CeramicSpeed product not live up to your expectations, and this is caused by defects in materials and/or workmanship, we encourage you to contact us.

Register your product within the first 30 days of purchase on [ceramicspeed.com/cycling](https://ceramicspeed.com/cycling/support) under the section Support. Should you thereafter, and within the warranty period need to file a claim, please return to the same section on our website and fill in your claim. We will always strive to revert to you concerning your claim within 24 hours.